

M 5220520  
0522  
0525

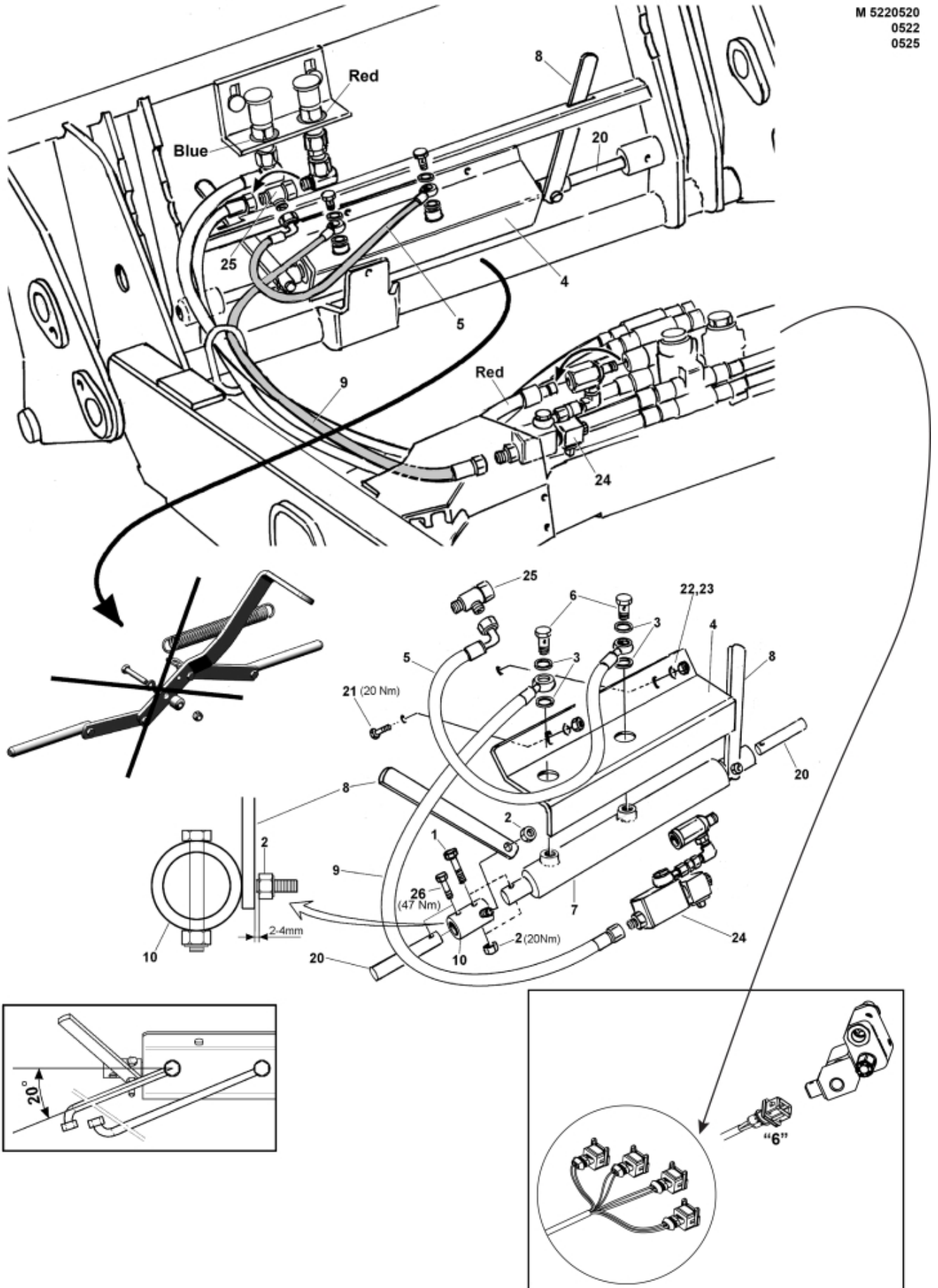

<b>Part assemblies</b>		Implement lock LCS		
<b>Specification</b>		Serial number to: 7332743		
<b>PartNo</b>	<b>Pos</b>	<b>Qty</b>	<b>Name</b>	<b>Specifications</b>
5220522		1 PCS	Implement lock LCS	7332743
5219046		1	Locking kit	
5002055	1	2	• Screw	M6S M8x40
5011553	2	4	• Nut	M6M M8 Loc-king
5013856	3	4	• Dowty washer	Tredo 1/4"
5219048	4	1	• Protection plate	
60000143	5	1 PCS	• Hose	1/4" L=550mm (9031170)
1120166	6	2	• Banjo fitting	R1/4"
12713210	7	1	• Cylinder	Ø25/16 L=370-590 Lock cyl.
60005579		1	•• Seal kit	Implement lock. cyl.
5219049	8	2	• Indicator	
60000135	9	1 PCS	• Hose	1/4" L=1100mm (9031482)
5219246	10	2 PCS	• Sleeve	
5219044	20	2	• Pin	D=20mm
5002077	21	2	• Screw	M6S 10x30
5011554	22	1	• Nut	Loc-King M10
5013110	23	1	• Washer	BRB 10.5x22x2
10550455	24	1 PCS	• Valve	
5027454	25	1	• L-coupling	
5002971	26	2	• Screw	M6S 10x30 Drilock
5033992		1	Safety switch cpl.	Replaces 5033991