

M 5220705
0706

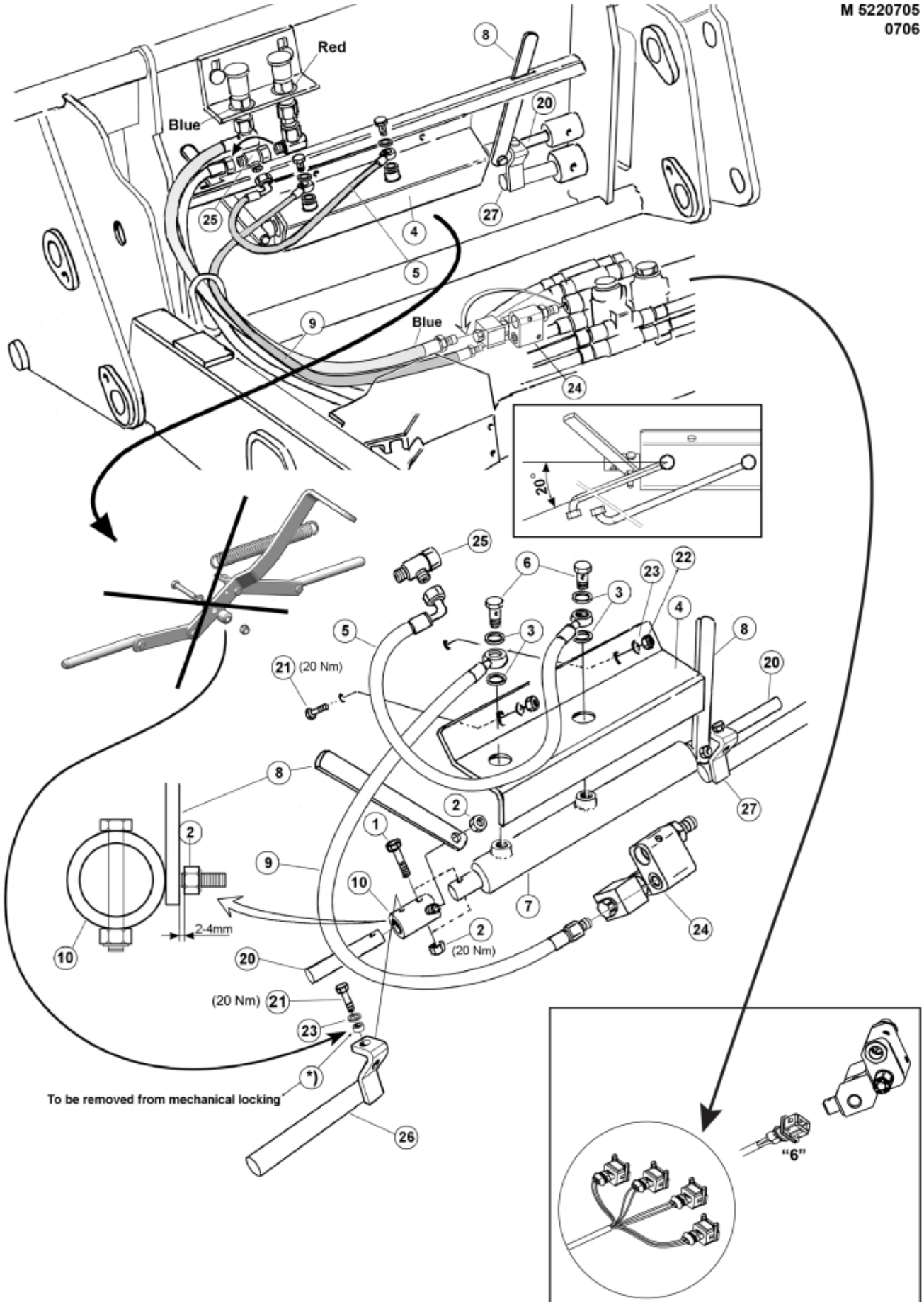

Part assemblies Implement lock
Specification Serial number from: 7332744

PartNo	Pos	Qty	Name	Specifications
5220705			Implement lock	7332744
5219242			Locking kit	6+8 DM
5002055	1	2	• Screw	M6S M8x40
5011553	2	4	• Nut	M6M M8 Loc-king
5013856	3	4	• Dowty washer	Tredo 1/4"
5219243	4	1	• Protection plate	
60000143	5	1 PCS	• Hose	1/4" L=550mm (9031170)
1120166	6	2	• Banjo fitting	R1/4"
12713210	7	1	• Cylinder	Ø25/16 L=370-590 Lock cyl.
60005579		1	•• Seal kit	Implement lock. cyl.
5219049	8	2	• Indicator	
60000135	9	1 PCS	• Hose	1/4" L=1100mm (9031482)
5219240	10	2	• Sleeve	
5219044	20	2	• Pin	D=20mm
5002077	21	2	• Screw	M6S 10x30
5011554	22	2	• Nut	Loc-King M10
5013110	23	2	• Washer	BRB 10.5x22x2
10550455	24	1 PCS	• Valve	
5027454	25	1	• L-coupling	
5219230	26	1	• Pin LH	D=30mm
5219231	27	1	• Pin RH	D=30mm
5201088		1 PCS	Safety switch	
5219100	*)	2	Spacer	