

Original Implements™

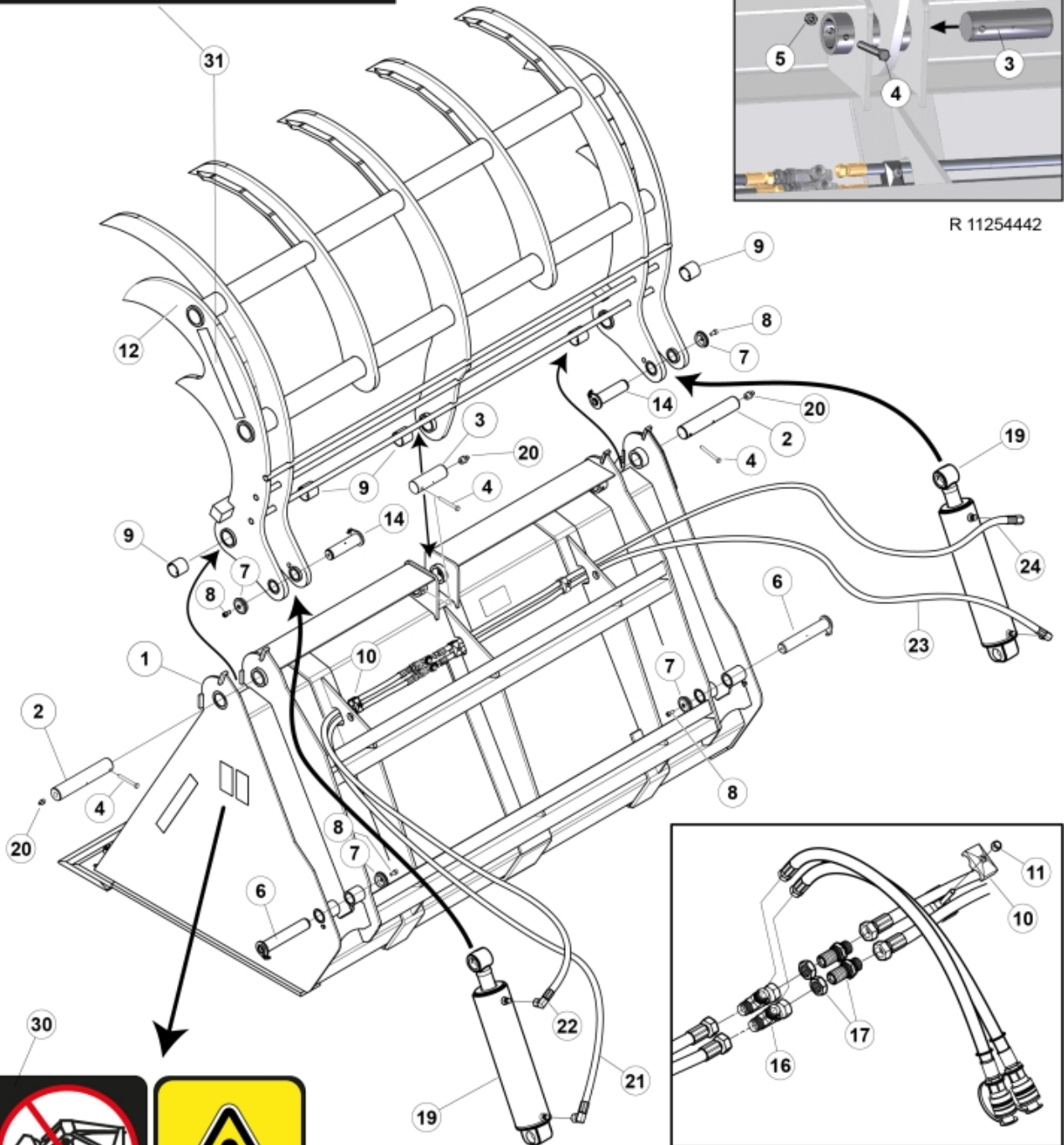

R 11254442

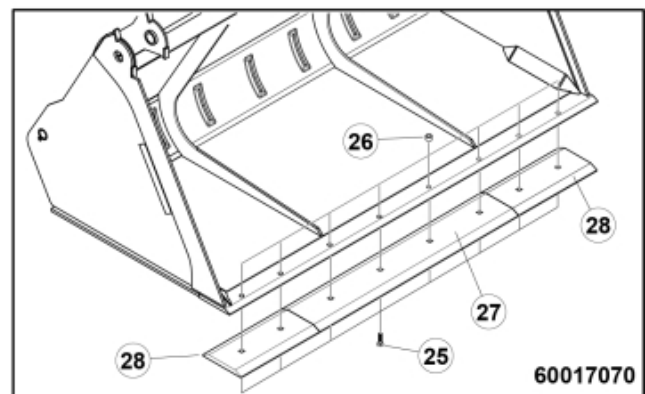
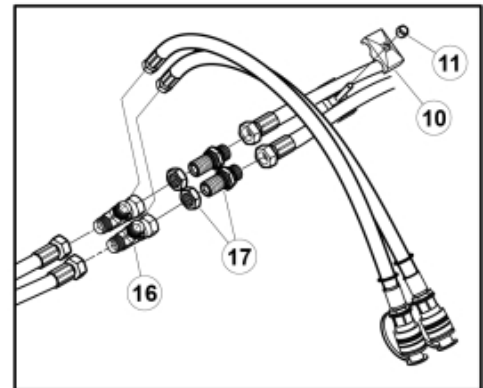

60017070

This block contains three safety-related icons. On the left, a black sign with a red prohibition symbol (a circle with a diagonal line) shows a person operating a machine, indicating that the machine should not be operated without proper training. On the right, a yellow warning sign with a black exclamation mark indicates a general warning. Below these is a yellow sign with a black icon of an open book, signifying that the operator must read the manual. The reference number 11 23 673 is associated with the prohibition sign, and 11 23 674 is associated with the warning sign.

Powergrab™ XL

Part assemblies Powergrab XL 220
Specification Year From: 01/01/2017 00:00:00

PartNo	Pos	Qty	Name	Specifications
11254442			Powergrab XL 220	01/01/2017 00:00:00
60017073	1	1 PCS	Bucket 220	Powergrab XL
60016512	2	2 PCS	Pin	D40 L=272
60016513	3	2 PCS	Pin	
5002991	4	4	Screw	M6S_M10x90 (8.8)
5011554	5	4	Nut	Loc-King M10
60016543	6	2 PCS	Pivot	
5215131	7	4	Locking cover	
5004917	8	4	Screw	
60016592	9	6 PCS	Bushing	
5016968	10	4	Hose clamp	
5011553	11	4	Nut	M6M M8 Loc-king
60017069	12	1 PCS	Grab head	XL 220
60019828	14	2	Pivot Pin	D=40, L=147mm
5028031	16	2	T-Adapter	
11120580	17	2	Adapter cpl.	
60014379	19	2 PCS	Cylinder	D110 Stroke 405
5023005	20	4	Greaser	M 10 x 1
60017092			Hose kit	
60016964	21	1 PCS	• Hose	L=1650
60016960	22	1 PCS	• Hose	L=1360
60016719	23	1 PCS	• Hose	L=1260
60017088	24	1 PCS	• Hose	L=960
60017070			Bolt on Cutting Edge kit	
5050650	25	10 PCS	• Plow bolt	3/4" - 2.5 inch
5050652	26	10	• Locking nut	UNC 3/4"
60017064-22	27	1 PCS	• Cutting edge	Centre
60016510-22	28	2 PCS	• Cutting edge	Outer
1123674	29	1	Warning decal	"Read manual"
1123673	30	1	Warning decal	
11137127	31	1 PCS	Decal	"Original Implements"
60016841	32	1 PCS	Decal	Powergrab XL