

R 619402

**VALVE (Commercial Hyd.)**

**VALVE (Intertraco)**

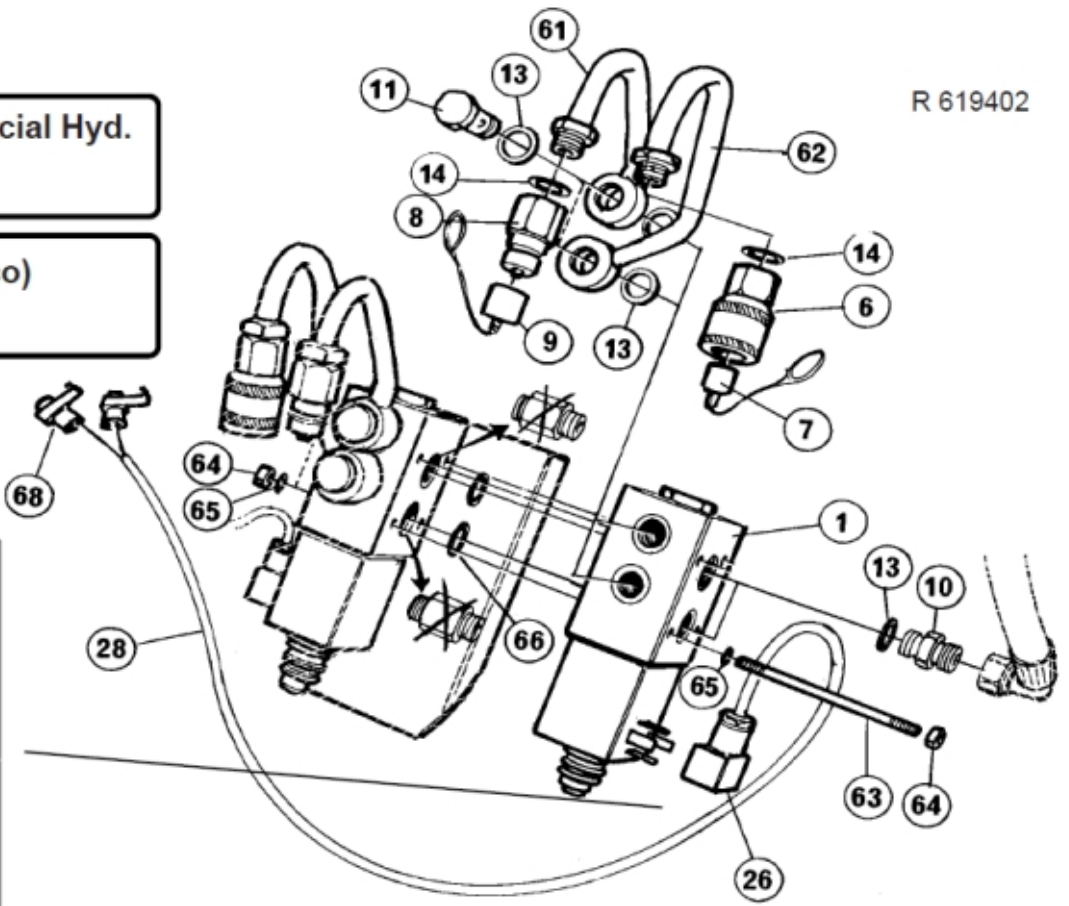
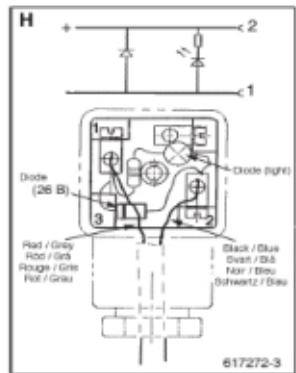

**Description** Q-310, 340, 415, 450 / 600 - 700 Series  
**Part assemblies** Selecto - Quick 4-th

PartNo	Pos	Qty	Name	Specifications
516071	1	1	Valve	
516091	1	1	Control valve	
5044127	6	1	Quick Coupling	1/2", Part is included in kit 60007907 Hose cpl., 9032177 Hose cpl.
5044130	7	1	Dust Cover	Part is included in kit 60007907 Hose cpl., 9032177 Hose cpl.
5044128	8	1	Quick Coupling	ISO-A Plug 1/2"
5044129	9	1	Dust Cover	1/2" Male
1120012	10	2	Adaptor	G 1/2"
1120241	11	2	Hollow screw	
5013853	13	6	Dowty washer	Tredo 1/2", Part is included in kit 60007907 Hose cpl., 9032177 Hose cpl.
5013604	14	2	Washer	Copper 21x28x2
5024369	26	1 PCS	Connector	
5024409	26 B	1	Diode	1 Amp./100V
5024202	28	1 M	Harness	
313486	61	1	Tube	
313487	62	1 PCS	Tube	
516073	63	4 PCS	Bolt	
5011053	64	2	Nut	M6M M8
5013101	65	2	Washer	BRB 8,4 x 16
5037021	66	2 PCS	O-ring	25.12x 1.78 (70 sh)
5024025	68	2	Jointing clamp	